

LANCOM OAP-821

Quick Reference Guide

... connecting your business



Mounting

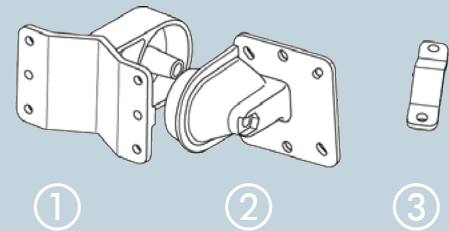

Screw the connector flange (2) to the back of the housing with the four screws and their washers.

Wall mounting

Use the mounting arm (1) as a template. Fix the mounting arm to the wall with the supplied screws and dowling plugs.

Pole mounting

Place the clamp profile (3) around the pole. Screw the clamp profile onto the mounting arm with the supplied screws.

Attach the access point with the connector flange (2) to the mounting arm (3). Use the M8 x 110 bolt with spring locking washer, washer and nut.

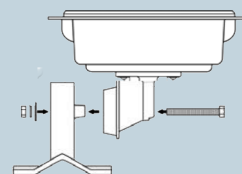

The main beam direction of the integrated antenna can be adjusted by tilting the access point up or down by rotating the connection flange about the mounting arm.

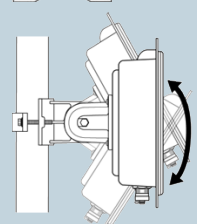

Observe the mounting instructions in the accompanying LANCOM Outdoor Wireless Guide. Installing access points and/or external antennas without adequate lightning protection can lead to serious damage to the devices and/or to the related network infrastructure. Screw one end of the green grounding wire to the housing and attach the other end to a suitable ground.

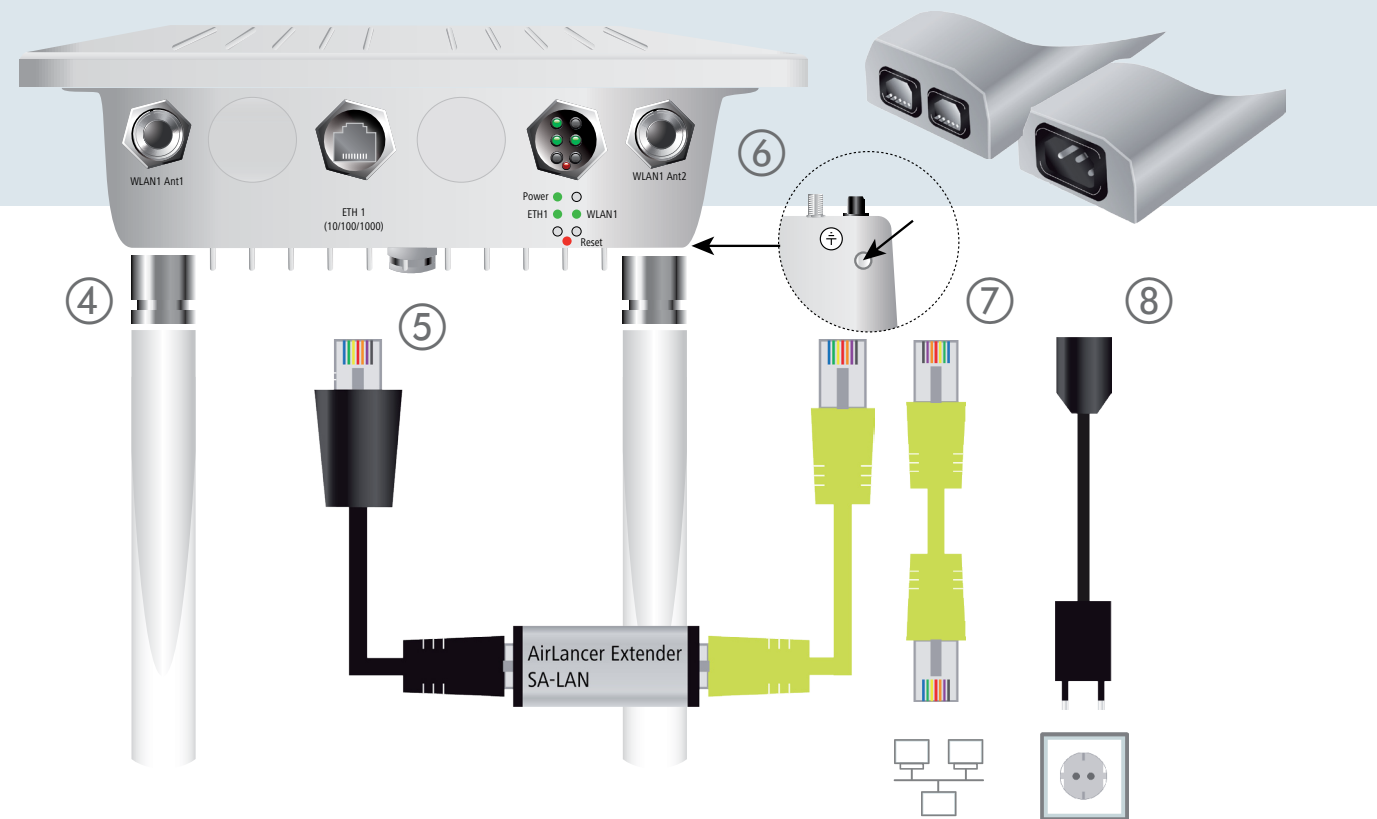

4 Optional: Antennas
For 2.4-GHz wireless links, screw the supplied dipole dual-band antennas to the two N connectors on the underside of the device. Antennas are only to be attached or changed when the device is switched off. Mounting or demounting antennas while the device switched on may cause the destruction of the WLAN module!

5 LAN and Power
The LAN connector also supplies the power to the LANCOM OAP-821. Plug in the water-proof power cable to the LAN port on the underside of the device and carefully tighten the threaded connector. Connect the other end of the power cable to the 'Power Out' connector on the supplied PoE Injector.

6 Reset
The reset switch is a part of the LED block. To restore the device to its default configuration, keep the reset button on the device pressed until the LEDs on the device go out. The automatic restart that follows restores the default configuration to the device.

7 LAN
Use a standard Ethernet cable to connect the LAN-In connector of the supplied PoE injector to an available network connector socket in your local network

8 Power
Supply power to the PoE injector. Only use the supplied PoE Injector to supply power to the LANCOM OAP-821. Pay particular care not to connect the PoE Injector to non-PoE Ethernet devices!



A LAN-side surge arrester AirLancer Extender SA-LAN is an essential requirement for outdoor installations. It is shipped as a standard component of LANCOM OAP-821 Bridge Kits.



The housing of the device may become warm during operation. If the device is operated with outside temperatures exceeding 60 °C, it should be mounted with protection against contact.

MOUNTING AND CONNECTING THE DEVICE



1 Power	
Off	Device switched off
Green, on (constant)	Device operational
Blinking green	Configuration password not set. Without a configuration password, the configuration data in the device is unprotected.

3 WLAN	
Off	No WLAN network defined or WLAN module deactivated. The WLAN module is not transmitting beacons.
Green	At least one WLAN network is defined and WLAN module activated. The WLAN module is transmitting beacons.
Green inverse flashing	Number of flashes = number of connected WLAN stations and P2P wireless connections, followed by a pause (default). Alternatively the frequency of the flashing can indicate signal strength over the defined P2P link or the signal strength between the access point and the device operating in client mode.
Blinking green	DFS scanning or other scan procedure

2 ETH 1	
Off	No networking device attached
Green, on (constant)	Connection to network device operational, no data traffic
Flickering green	Data traffic

Hardware	
Power supply	Via Power-over-Ethernet compliant to IEEE 802.3af
Power consumption	Maximum of 11 watts, measured on the PoE injector
Environment	-33°C to +70°C
Housing	Robust metal housing, protection class IP 66 for wall and pole mounting. Note: For installations in salt-water environments, use a suitable protective housing Dimensions 255 mm x 250 mm x 80 mm (length/width/depth) Weights ca. 2.8 kg incl. the full pole-mounting equipment
LED displays	3 LEDs for Power, Ethernet and WLAN
WLAN	
Frequency band	2.4 GHz or 5 GHz, 2400-2483.5 MHz (ISM) or 5150-5825 MHz (restrictions vary between countries)
Antenna gain	Up to 18 dBi at 5 GHz on the integrated dual polarization antenna
Range (outdoor/P2P)	The Antenna Distance Calculator is available for free from www.lancom.eu.
Radio channels 2.4 GHz	Up to 13 channels, max. 3 non-overlapping (2.4-GHz band)
Radio channels 5 GHz	Up to 26 non-overlapping channels (channels available vary according to country regulations; DFS for automatic dynamic channel selection required)
Interfaces	
LAN	10/100/1000 Mbps auto-sensing, PoE as per IEEE 802.3af
External antenna connectors	Two N ports
Internal antenna	15° beam angle, 2x2 MIMO, 5 GHz, 18dBi antenna gain
Declaration of conformity	
The Declaration of Conformity can be found on the product page of our website www.lancom.eu	
Package content	
Cable	Per LANCOM OAP-821; one waterproof, UV resistant Ethernet PoE cable, screw connector at one end, 15m
Manual	Quick Reference Guide (DE/EN), Installation Guide (DE/EN/FR/ES/IT/PT/NL)
DVD	CD/DVD with management software (LANconfig, LANmonitor, LANCAPI) and documentation
Antennas	Two 3-dBi dipole dual-band antennas (not included with the Bridge Kit)
Power adapter	Via Power over Ethernet; one PoE Injector supplied per LANCOM OAP-821
Mounting kit	Equipment for wall and pole mounting, screws included
Covering cap	Ensures that the unit remains sealed in case an Ethernet port is unused
Grounding cable	To avoid electrostatic charge

LANCOM, LANCOM Systems and LOGS are registered trademarks. All other names or descriptions used may be trademarks or registered trademarks of their owners. Subject to change without notice. No liability for technical errors and/or omissions. 1112830715

TECHNICAL DETAILS